



Embedded System Laboratories Pvt. Ltd.

(An ISO 9001:2015 certified company)

86, Lane No. 7, Near Laxmi Dairy, Gurudwara Road, Jawahar Colony,
N.I.T. Faridabad - 121005, Haryana, India

Phone :- +91-129-2230671 Mob. +91-9811482048, 9311482051

Website :- www.eslpl.com E-mail :- eslfaridabad@yahoo.com

COMPRESSION - TYPE LOAD CELL

DESCRIPTION

EC are high performance, low cost, Shear S-type loadcell with excellent sensitivity and repeatability. The design is suggested for the Tension and Compression, hanging type-weighing application, which includes Testing Machines, Tank Weighing, Hopper Weighing, Mechanical Platform Scales and Weigh-bridges etc. And are also very widely used for the conversion of the existing machines to electronics.



PERFORMANCE SPECIFICATION

Rated Capacities (Kg.)	10,25,50,100,200,250,300,500 kg, 1,2,3,5,7.5,10 Tonne
Rated Output	2mV/V±10%
Non-linearity	< ± 0.02% of Full Scale
Creep (30 Mins)	< ± 0.03% of Full Scale
Zero	< ± 2% of Full Scale
Hysteresis	< ± 0.02% of Full Scale
Repeatability	< ± 0.02% of Full Scale
Temp. Effect on Output	< ± 0.012% Load / 10°C
Temp. Effect on Zero	< ± 0.02% R.O. / 10°C
Compensated Temp. Range	-10°C to 50°C
Operating Temp. range	-20°C to 60°C
Safe Overload	150 % of Rated Capacity
Input Impedance	400 ± 30 Ohms
Output Impedance	350 ± 3 Ohms
Insulation Resistance	> 2000 Mohms (50 VDC)
Recommended Excitation	5 - 12 VDC
Maximum Excitation	15 VDC
Cable Connection	Input: Red (+) White (-) Output: Green(+) Blue(-)

DIMENSIONS:-

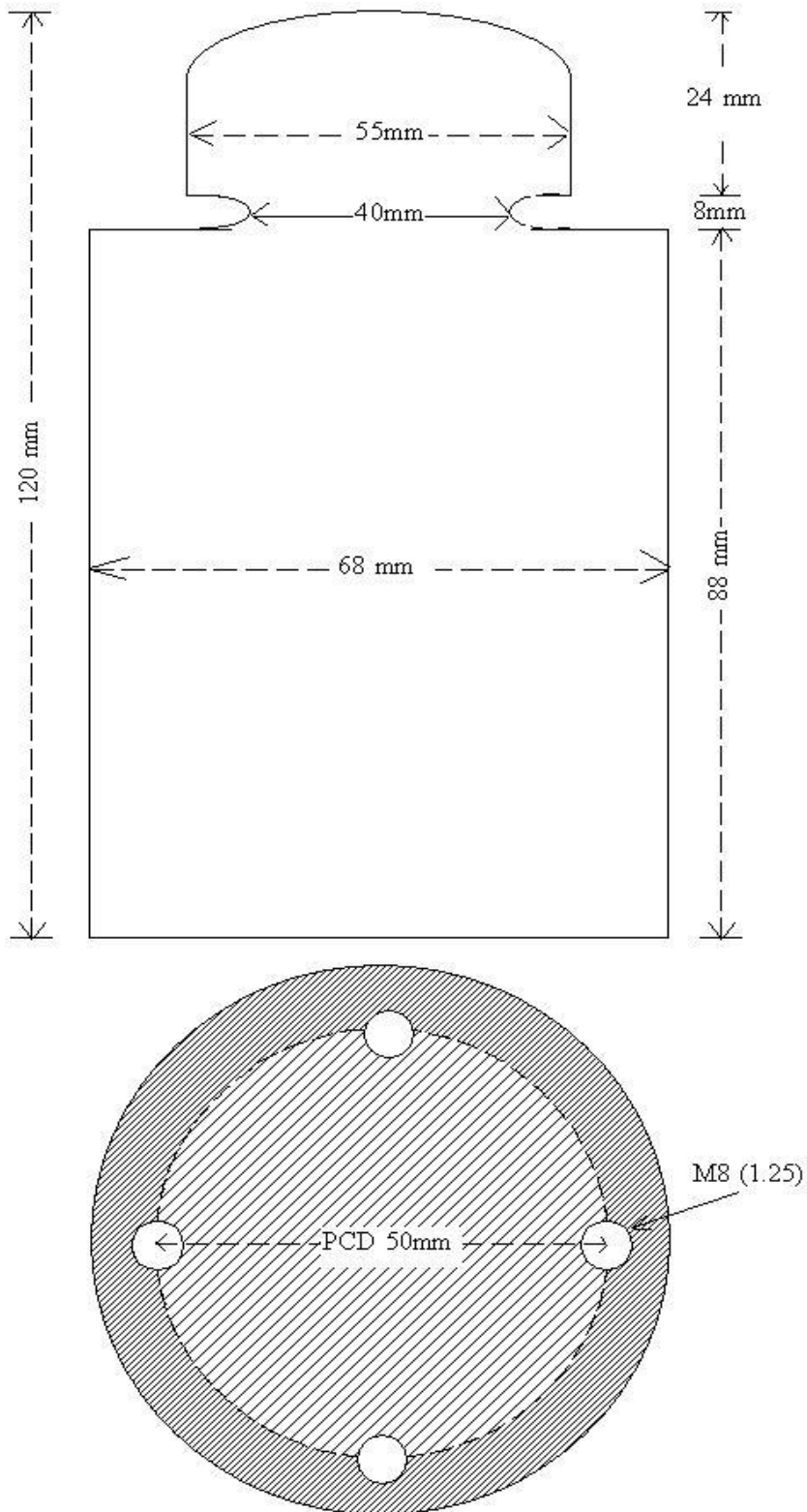

All dimensions are in mm (inch)

Specification subjected to change without notice.

FEATURES

- Special grade electro-less nickel-plated tool steel construction
- Economically priced, low cost
- High Accuracy 0.03%
- Wide capacity range 10 tonne to 30 tonne.
- Loadcell can be used in Compression